

ZTA - DIP Series of Ceramic Resonator

1.79 - 60.00MHz

ZTA□MT/MX Series

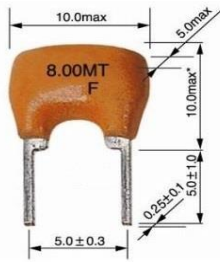

ZTARS□MG Series

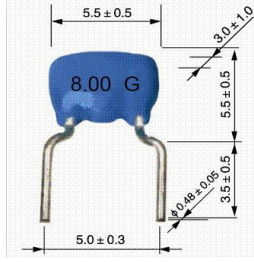

ZTAWs□MG Series

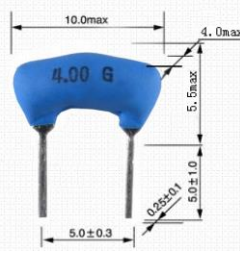

● TEST CIRCUIT FOR MOS IC

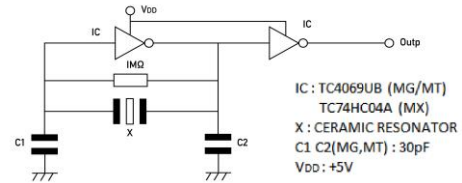

| Part Number | Frequency Range | Circuit Constants | |
|-------------|-----------------|-------------------|---------|
| | | C1 (PF) | C2 (PF) |
| ZTA□MX | 12.00 - 20.00 | 30 | 30 |
| | 20.01 - 25.99 | 15 | 15 |
| | 26.00 - 60.00 | 5 | 5 |

● TECHNICAL CHARACTERISTICS

| Part Number | Frequency Range (MHz) | Frequency Accuracy (25°C) | Stability Temperature (-20~+80°C) max.(%) | Operating Temperature (°C) | Aging For Ten Year (%) |
|-------------|-----------------------|---------------------------|---|----------------------------|------------------------|
| ZTA□MT | 6.00 - 13.00 | ±0.5 | ±0.3 | -25 ~ +85 | ±0.3 |
| ZTA□MX | 12.00 - 60.00 | ±0.5 | ±0.3 | -25 ~ +85 | ±0.3 |
| ZTARS□MG | 8.00 - 12.50 | ±0.5 | ±0.3 | -25 ~ +85 | ±0.3 |
| ZTAWs□MG | 1.79 - 6.00 | ±0.5 | ±0.3 | -25 ~ +85 | ±0.3 |

ZTA - SMD Series of Ceramic Resonator

1.80 - 60.00MHz

● DIMENSIONS (UNIT : mm)

ZTACC□MG Series

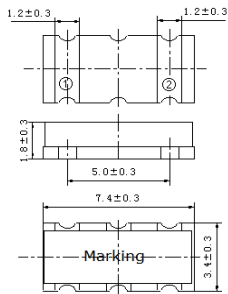

① Input ② Output

ZTACP□MG Series

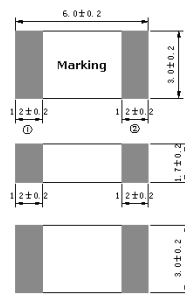

ZTACS□MT/MX Series

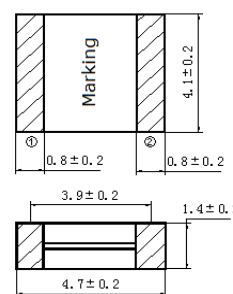

ZTACV□MT/MX Series

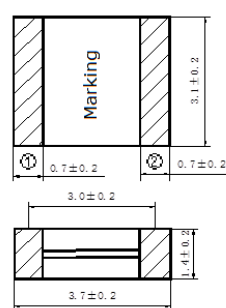

ZTACW□MX Series

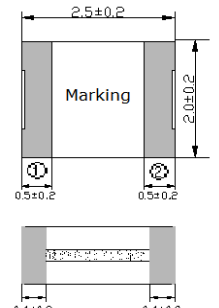

● RECOMMENDED LAND PATTERN

ZTACR□MG Series

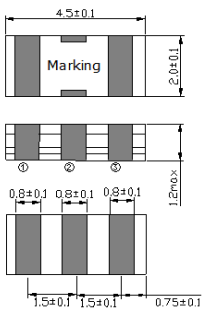

① Input
② NC
③ Output

ZTACC□MG Series
ZTACP□MG Series
ZTACS□MT/MX Series
ZTACV□MT/MX Series
ZTACW□MX Series

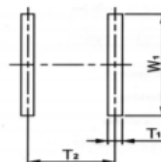

ZTACR□MG Series

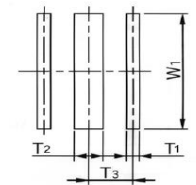

| Part Number | Size Code | DIMENSIONS (UNIT : mm) | | | |
|-------------|-----------|------------------------|---------|---------|---------|
| | | T1 | T2 | T3 | W1 |
| ZTACC□MG | | 1.2±0.2 | 5.0±0.2 | - | 3.4±0.2 |
| ZTACP□MG | | 1.2±0.2 | 4.8±0.2 | - | 3.0±0.2 |
| ZTACR□MG | | 0.8±0.2 | 3.9±0.2 | - | 4.1±0.2 |
| ZTACS□MT/MX | | 0.7±0.2 | 3.0±0.2 | - | 3.1±0.2 |
| ZTACV□MT/MX | | 0.4±0.2 | 2.0±0.2 | - | 2.0±0.2 |
| ZTACW□MX | | 0.8±0.1 | 0.8±0.1 | 1.5±0.1 | 2.0±0.1 |

● TECHNICAL CHARACTERISTICS

| Part Number | Frequency Range (MHz) | Frequency Accuracy (25°C) | Stability Temperature (-20~+85°C) max.(%) | Operating Temperature (°C) | Aging For Ten Year (%) |
|-------------|-----------------------|---------------------------|---|----------------------------|------------------------|
| ZTACC□MG | 1.80 - 8.00 | ±0.5 | ±0.3 | -25 ~ +85 | ±0.3 |
| ZTACP□MG | 1.80 - 12.00 | ±0.5 | ±0.2 | -40 ~ +125 | ±0.1 |
| ZTACR□MG | 4.00 - 8.00 | ±0.5 | ±0.3 | -25 ~ +85 | ±0.3 |
| ZTACS□MT | 6.00 - 13.00 | ±0.5 | ±0.4 | -25 ~ +85 | ±0.3 |
| ZTACV□MT | 8.00 - 13.00 | ±0.5 | ±0.4 | -25 ~ +85 | ±0.3 |
| ZTACS□MX | 13.01 - 60.00 | ±0.5 | ±0.3 | -25 ~ +85 | ±0.3 |
| ZTACV□MX | 16.00 - 60.00 | ±0.5 | ±0.3 | -25 ~ +85 | ±0.3 |
| ZTACW□MX | 20.00 - 60.00 | ±0.5 | ±0.3 | -25 ~ +85 | ±0.3 |